

立体声耳机 Stereo Headphones

使用说明书
Operating Instructions

MDR-XB41EX

©2010 索尼公司 泰国印刷
Sony Corporation Printed in Thailand

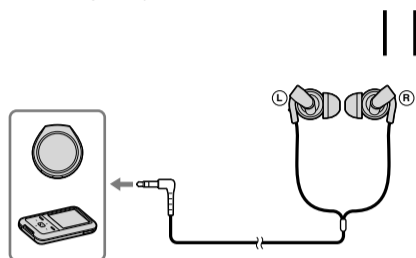

A

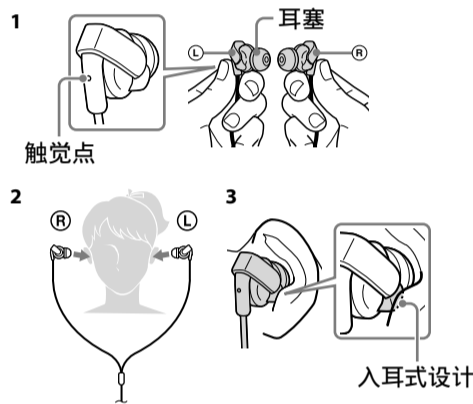

B

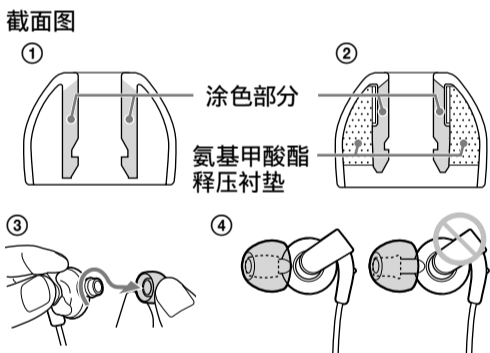

C

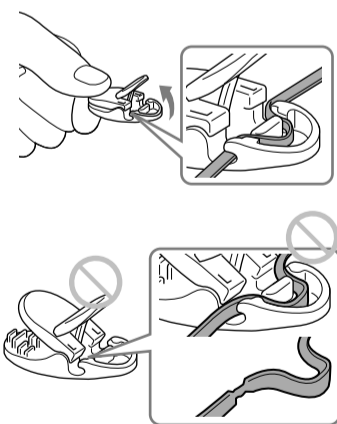

D

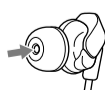

立体声耳机

操作本机之前, 请仔细阅读本手册并妥善保管以备将来参考。

特点

- 直接振动结构提供声学密封, 实现良好的声音隔离和低沉声音。
- 13.5 mm大直径驱动单元, 再现强劲动态低音。
- 弹性外罩改善与耳朵的贴合度, 实现低音的完整传送。
- 封闭型垂直入耳式耳机, 便于舒适佩戴。
- 新开发的稳定设计使佩戴更牢固。
- 4种尺寸混合硅胶耳塞, 适合长时间稳固舒适佩戴 (SS、S、M、L)
- 3种尺寸噪音隔离耳塞, 实现环境噪音的有效衰减 (S、M、L)
- 耐用扁平导线。
- 提供便利的携带袋。

使用方法

佩戴耳机 (见图A)

- 1 确定左右耳机, 并如图所示拿着。
- 2 如图所示, 将耳机舒适地塞入您的耳朵。
- 3 调整耳塞使其舒适地贴合您的耳朵。

正确安装耳塞 (见图B)

如果耳塞不适合您的耳朵, 则可能听不到低音。为了欣赏更佳音质, 请更换耳塞尺寸或类型, 或调节耳塞位置以舒适贴合您的耳朵。如果耳塞不适合您的耳朵, 请尝试其他尺寸或类型的耳塞。通过查看内部颜色确认耳塞尺寸 (混合硅胶耳塞见图B-①, 噪音隔离耳塞见图B-②)。更换耳塞时, 请将其牢牢安装在耳机上, 以防止耳塞脱落落在您耳朵内。

关于混合硅胶耳塞 (见图B-①)

耳塞尺寸 (内部颜色)

小 ←	SS (红色)	S (橙色)	M (绿色)	L (浅蓝色)	→ 大
-----	---------	--------	--------	---------	-----

清洁混合硅胶耳塞

从耳机上拆下耳塞, 用中性清洁剂溶液清洗。

关于噪音隔离耳塞 (见图B-②)

附带的噪音隔离耳塞紧贴耳朵并有效减少环境噪音。

耳塞尺寸 (内部颜色)

小 ←	S (橙色)	M (绿色)	L (浅蓝色)	→ 大
-----	--------	--------	---------	-----

注意

- 长时间使用噪音隔离耳塞可能会因为其紧贴耳朵而使耳朵受伤。如果您的耳朵感到不适或疼痛, 请停止继续使用。
- 氨基甲酸酯释压衬垫非常柔软。因此, 请勿捏拉氨基甲酸酯衬垫。如果氨基甲酸酯衬垫破损或从耳塞上脱落, 则耳塞位置会不正确并失去噪音隔离功能。
- 氨基甲酸酯衬垫可能由于长期存放或使用而老化。如果没有释压能力且氨基甲酸酯衬垫变硬, 则耳塞可能失去噪音隔离功能。
- 请勿清洗噪音隔离耳塞。使耳塞保持干燥, 避免氨基甲酸酯释压衬垫积水。否则可能会导致过早老化。

取下耳塞 (见图B-③)

握住耳机的同时, 转动耳塞内侧部件将其拔下。

提示

如果耳塞较滑无法拆下, 请用柔软干布将其包住。

装上耳塞 (见图B-④)

将耳塞内侧部件推入耳机, 直至完全盖住耳机的突出部分。

如何将线夹安装到耳机线上 (见图C)

- 1 合上线夹, 然后将线夹上的杆子稍稍向上拉起。
- 2 将耳机线放入杆子下面的凹槽中。

注意

- 如果您在没有合上线夹的情况下拉起线夹上的杆子, 或者合上了线夹但是将杆子拉起的幅度过大, 则无法将耳机线放入杆子下面的凹槽中。
- 请勿将耳机线夹在线夹的突起部位上, 或者将其嵌入槽中。否则可能会损坏耳机线中的线芯。
- 请勿在夹住耳机线时移动线夹位置。否则可能会损坏耳机线中的线芯。

规格

类型: 封闭式, 动态 / 驱动单元: 13.5 mm

产品中有毒有害物质或元素的名称及含量

使用环境条件: 5度~35度

(○: 不含有, ×: 含有)

部件名称	有毒有害物质或元素					
	铅 (Pb)	汞 (Hg)	镉 (Cd)	六价铬 (Cr(VI))	多溴联苯 (PBB)	多溴二苯醚 (PBDE)
外壳	×	○	○	○	○	○
附件	○	○	○	○	○	○

○: 表示该有毒有害物质在该部件所有均质材料中的含量均在 SJ/T11363-2006 标准规定的限量要求以下。

×: 表示该有毒有害物质至少在该部件的某一均质材料中的含量超出 SJ/T11363-2006 标准规定的限量要求。

(采用CCAW), 圆顶型 / 功率处理容量: 100mW (IEC*) / 阻抗: 1 kHz时16 Ω / 灵敏度: 105 dB/mW / 频率响应: 4 - 24000 Hz / 导线: 1.2 m, Y型, 扁平导线 / 插头: 镀金L形立体声迷你插头 / 质量: 约 8 g, 不包括导线 / 附件: 混合硅胶耳塞 (SS (2), S (2), M (2), L (2)), 噪音隔离耳塞 (S (2), M (2), L (2)), 携带袋 (1), 线夹 (1), 使用说明书 (1)

* IEC = 国际电工委员会

设计和规格如有变更, 恕不另行通知。

注意事项

- 请始终保持耳机清洁, 尤其是橡胶耳塞内部 (见图D)。
- 如果灰尘或耳垢进入耳塞, 聆听效果可能不佳。
- 戴着耳机以高音量收听可能会影响您的听力。为了交通安全, 请勿在驾车或骑车时使用。
- 请小心操作驱动单元。
- 请勿在耳机上放置重物或对其施加压力, 否则在长期存放过程中可能会造成耳机变形。
- 耳塞可能会由于长期存放或使用而老化。
- 将耳塞牢固安装在耳机上。如果耳塞意外脱落落在您的耳内, 可能会造成伤害。
- 请将耳塞存放在儿童无法拿到的地方, 以免意外吞入或窒息。
- 请勿将立体声耳机放置在受阳光直射、靠近热源或有湿气的地方。

静电注意事项

在特别干燥的空气条件下, 耳朵可能会感到轻微刺痛。这是由于体内积聚的静电所致, 而非耳机故障。穿着天然材料制成的衣服可将此影响减到最少。

您最近的Sony代理商能提供选配的替换耳塞。

For China Market Only:

制造商: 索尼公司
地址: 日本国东京都港区港南1-7-1
总经销商: 索尼(中国)有限公司
地址: 北京市朝阳区东三环北路
霞光里18号佳程大厦A座25层
原产地: 泰国
出版日期: 2010年12月



Stereo headphones

Features

- Direct Vibe Structure provides an acoustically-tight seal for superior sound isolation and deep bass sound.
- Large 13.5 mm diameter driver units reproduce powerful and dynamic bass sound.
- Elastomeric housing for improved adherence to the ears for full transmission of bass sound.
- Closed type vertical in-the-ear headphones for good wearing comfort.
- Newly developed stay-in design for a more secure fit.
- 4 sizes of hybrid silicone rubber earbuds for secure fit and long-term wearing comfort (SS, S, M, L)
- 3 sizes of noise isolation earbuds for effective attenuation of ambient noise (S, M, L)
- Durable flat cord.
- Convenient carrying pouch supplied.

How to use

Wearing the headphones (see fig. A)

- 1 Determine right and left headphone and hold them as in the illustration.
- 2 Fit the headphones into your ears snugly, as in the illustration.
- 3 Adjust the earbud to fit snugly in your ear.

How to install the earbuds correctly

(see fig. B)

If the earbuds do not fit your ears correctly, low-bass sound may not be heard. To enjoy better sound quality, change the earbuds to another size or type, or adjust the earbuds position to sit on your ears comfortably and fit your ears snugly. If the earbuds do not fit your ears, try another size or type. Confirm the size of the earbuds by checking the colour inside (see fig. B-① for hybrid silicone rubber earbuds and B-② for noise isolation earbuds).

When you change the earbuds, install them firmly on the headphones to prevent the earbud from detaching and remaining in your ear.

About hybrid silicone rubber earbuds (see fig. B-①)

Earbud sizes (inside colour)

Small		Large
SS (Red)	S (Orange)	M (Green)
		L (Light blue)

To clean the hybrid silicone rubber earbuds

Remove the earbuds from the headphones, and wash them with a mild detergent solution.

About noise isolation earbuds (see fig. B-②)

Supplied noise isolation earbuds provides a snug fit for effective attenuation of ambient noise.

Earbud sizes (inside colour)

Small		Large
S (Orange)	M (Green)	L (Light blue)

Notes

- Prolonged use of the noise isolation earbuds may strain your ears due to their snug fit. If you have experience discomfort or pain in your ears, discontinue use.
- The pressure-relieving urethane cushion is extremely soft. Therefore, do not pinch or pull the urethane cushion. If the urethane cushion is broken or detached from the earbuds, it will not take its correct position and the earbuds will lose their noise isolation function.
- The pressure-relieving urethane cushion may deteriorate due to long-term storage or use. If the pressure-relieving power is lost and the urethane cushion becomes hard, the earbuds may lose their noise isolation function.
- Do not wash the noise isolation earbuds. Keep them dry, and avoid accumulation of water in the pressure-relieving urethane-cushions. Not doing so may cause early deterioration.

To detach an earbud (see fig. B-③)

While holding the headphone, twist the parts inside of the earbud and pull the earbud off.

Tip

If the earbud slips and cannot be detached, wrap it in a dry soft cloth.

To attach an earbud (see fig. B-④)

Push the parts inside of the earbud into the headphone until the projecting part of the headphone is fully covered.

How to attach the clip to the cord

(see fig. C)

- 1 Hold the clip closed, and pull up the lever on the clip just a little.
- 2 Put the cord into the groove under the lever.

Notes

- If you pull up the lever on the clip without holding the clip closed, or holding the clip closed but opening the lever too much, you cannot put the cord into the groove under the lever.
- Do not catch the cord on the projection of the clip or do not wedge it into the groove. It may damage the wires of the cord.
- Do not move the clip position with the cord attached. It may damage the wires of the cord.

Specifications

Type: Closed, dynamic / Driver unit: 13.5 mm (CCAW adopted), dome type / Power handling capacity: 100 mW (IEC*) / Impedance: 16 Ω at 1 kHz / Sensitivity: 105 dB/mW / Frequency response: 4 – 24,000 Hz / Cord: 1.2 m (47 1/4 in), Y type, flat cord / Plug: Gold-plated L-shaped stereo mini plug / Mass: Approx. 8 g (0.32 oz) without cord / Supplied accessories: Hybrid silicone rubber earbuds (SS (2), S (2), M (2), L (2)) / Noise isolation earbuds (S (2), M (2), L (2)), Carrying pouch (1), Clip (1), Operating Instructions (1)
* IEC = International Electrotechnical Commission
Design and specifications are subject to change without notice.

Precautions

- Please keep your headphones clean at all times especially inside the rubber earbud. (see fig. D)
If any dust or ear wax is inside the earbud, you may experience some listening difficulties.
- Listening with headphones at high volume may affect your hearing. For traffic safety, do not use while driving or cycling.
- Handle the driver units carefully.
- Do not put weight or pressure on the headphones as it may cause the headphones to deform during long storage.
- The earbuds may deteriorate due to long-term storage or use.
- Install the earbuds firmly onto the headphones. If an earbud accidentally detaches and is left in your ear, it may cause injury.
- Store the earbuds where children cannot reach in order to prevent from accidental ingestion or choking.
- Do not leave the stereo headphones in a location subject to direct sunlight, heat or moisture.

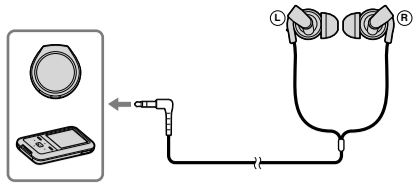

A

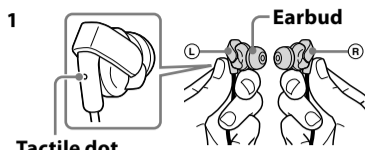

Tactile dot

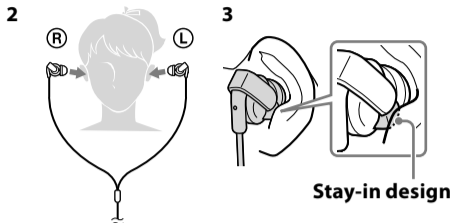

B

Sectional View

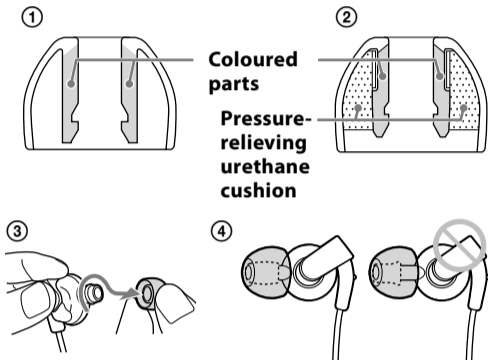

C

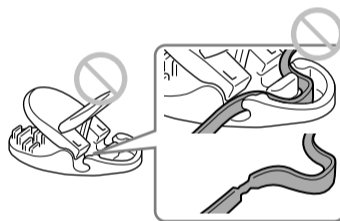
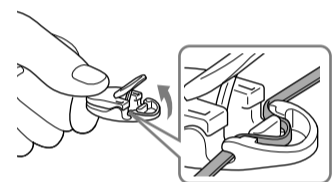

D

